

Idler wheels

Example of application

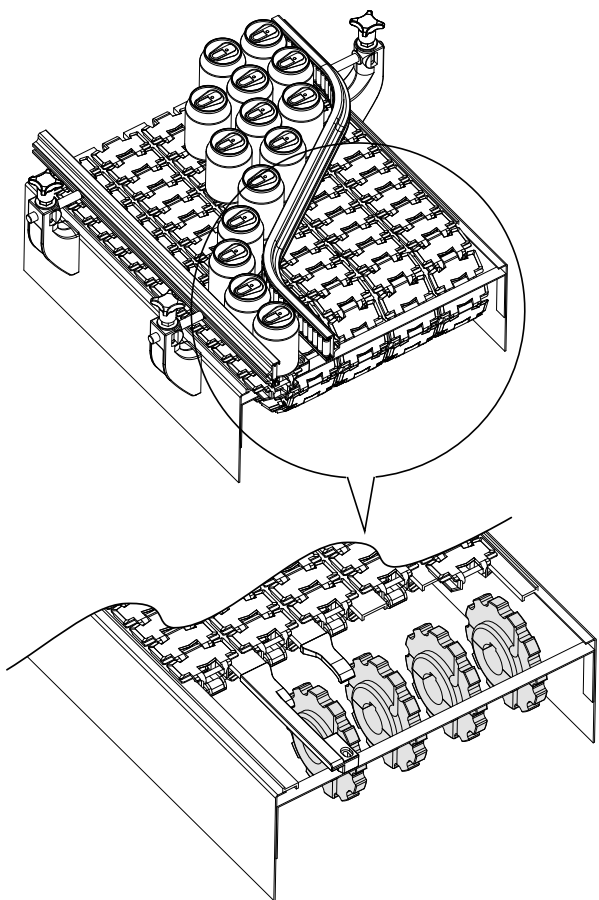

Split sprocket 10 teeth

(machined, for chains series 879, 879 TAB, 880, 880 TAB)

Part. **583**

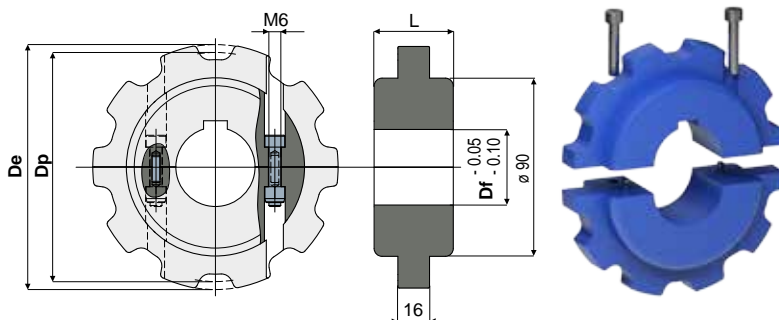

| L = 40 | | | |
|---------|---------|---------|-------------|
| Df (mm) | Dp (mm) | De (mm) | Code |
| 25 | 123,3 | 121,4 | 583 / 90961 |
| 30 | 123,3 | 121,4 | 583 / 90962 |
| 35 | 123,3 | 121,4 | 583 / 90963 |
| 40 | 123,3 | 121,4 | 583 / 90964 |

| L = 42,5 | | | |
|----------|---------|---------|-------------|
| Df (mm) | Dp (mm) | De (mm) | Code |
| 25 | 123,3 | 121,4 | 583 / 91362 |
| 30 | 123,3 | 121,4 | 583 / 91363 |
| 35 | 123,3 | 121,4 | 583 / 91364 |
| 40 | 123,3 | 121,4 | 583 / 91365 |

NEW
NEW
NEW
NEW

MATERIALS: Wheel made of polyamide blue Ral 5005 colour; screws made of stainless steel AISI 304, nuts in nickel plated brass.

FEATURES: Dimensions of the keyway UNI 6604-69 - DIN 6885/1. To be used with chains Part.710, 711, 713.

BOX QUANTITY: 8 pieces.

ON REQUEST:

- Wheels: With 18 mm. hole diameter to be machined.
- Wheels: In polyamide blue Ral 5005 FDA APPROVED.
- Box quantity: According to your request.

Split idler wheel 10 teeth

(machined, for chains series 879, 879 TAB, 880, 880 TAB)

Part. **582**

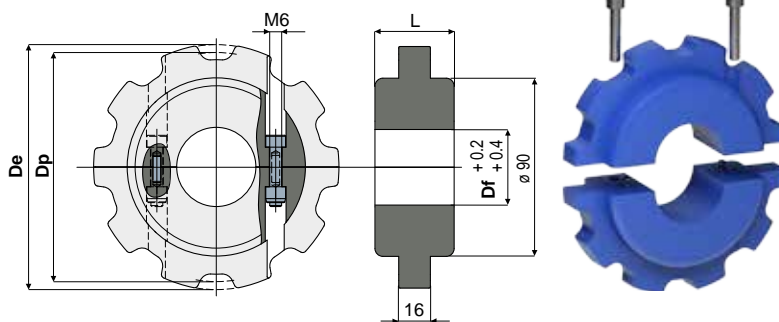

| L = 40 | | | |
|---------|---------|---------|-------------|
| Df (mm) | Dp (mm) | De (mm) | Code |
| 25 | 123,3 | 121,4 | 582 / 90957 |
| 30 | 123,3 | 121,4 | 582 / 90958 |
| 35 | 123,3 | 121,4 | 582 / 90959 |
| 40 | 123,3 | 121,4 | 582 / 90960 |

| L = 42,5 | | | |
|----------|---------|---------|-------------|
| Df (mm) | Dp (mm) | De (mm) | Code |
| 25 | 123,3 | 121,4 | 582 / 91358 |
| 30 | 123,3 | 121,4 | 582 / 91359 |
| 35 | 123,3 | 121,4 | 582 / 91360 |
| 40 | 123,3 | 121,4 | 582 / 91361 |

NEW
NEW
NEW
NEW

MATERIALS: Wheel made of polyamide blue Ral 5005 colour; screws made of stainless steel AISI 304, nuts in nickel plated brass.

FEATURES: To be used with chains Part.710, 711, 713.

BOX QUANTITY: 8 pieces.

ON REQUEST:

- Wheels: With 18 mm. hole diameter to be machined.
- Wheels: In polyamide blue Ral 5005 FDA APPROVED.
- Box quantity: According to your request.