

# Bearing supports

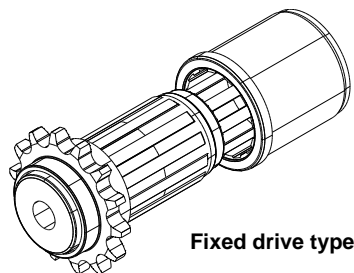

Fixed drive type

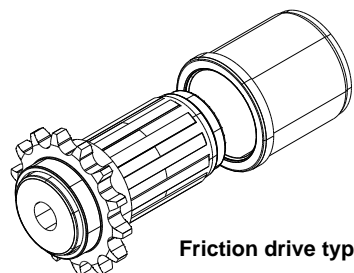

Friction drive type

Roller chain type DIN 8187 tipo 08-B1

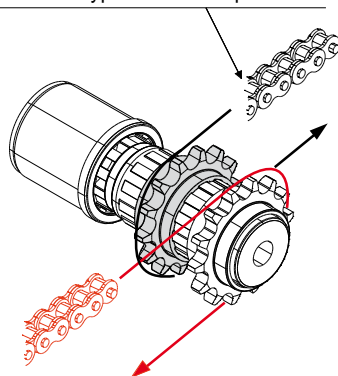

Example of assembly

## 14 teeth bearing support for conveyor rollers (for drive roller)

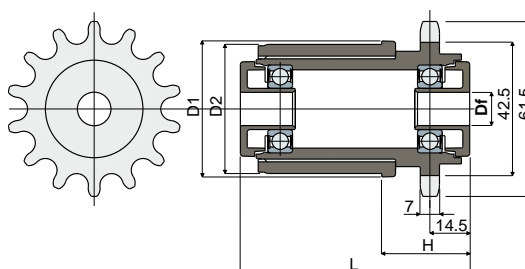
Part. **264**

Pressure fitted

Tube dimensions							Bore for pin	Fixed drive type	Friction drive type	Bearing type	Max Recommended load (N)
Outside ø	Thickness	Inside ø	D1	D2	H	L	Df	Code	Code		
(mm)	(mm)	(mm)	(mm)	(mm)	(mm)	(mm)	(mm)				
50	1,5	47	50	47	32	83	12	264 / 82033	264 / 82217	6002-2RS	200
50	1,5	47	50	47	32	83	14	264 / 82215	264 / 82218	6002-2RS	
60	1,5	57	60	57	39	83	12	264 / 85074	264 / 84244	6002-2RS	
60	1,5	57	60	57	39	83	14	264 / 85075	264 / 84245	6002-2RS	
60	2	56	60	56	39	83	12	264 / 85076	264 / 84246	6002-2RS	
60	2	56	60	56	39	83	14	264 / 85077	264 / 84247	6002-2RS	
60	2,75	54,5	60	54,5	39	83	12	264 / 85078	264 / 84251	6002-2RS	
60	2,75	54,5	60	54,5	39	83	14	264 / 85079	264 / 84253	6002-2RS	

**MATERIALS:** Bearing support with protective shield made of polyamide grey colour; external bushing made of polyamide black colour; bearing made of chrome steel.

**FEATURES:** To be inserted in the tube sides to build a roller conveyor. Drive sprocket with 14 teeth for roller chain type DIN 8187-08-B1.

**BOX QUANTITY:** 24 pieces.

**ON REQUEST:**

- Bearing supports: Bores with different sizes, other colours.
- Box quantity: According to your request.

## 14 teeth sprocket Part. **265** (for bearing support Part. 264)

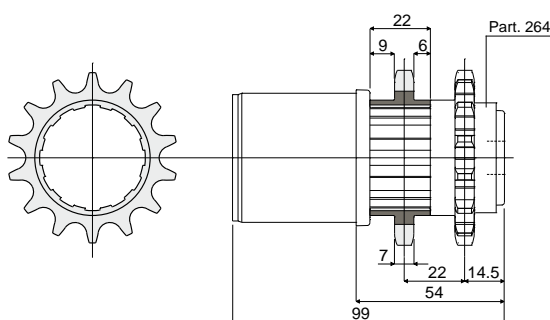

Code
265 / 82034

**MATERIALS:** Drive sprocket is made of polyamide black colour.

**FEATURES:** Accessory to be used with bearing support Part.264 to make the drive roller to roller. This drive type allows a greater torque.

**BOX QUANTITY:** 24 pieces.

**ON REQUEST:**

- Sprockets: Other colours.
- Box quantity: According to your request.