

# Knobs and handles

**Round handle** Part. **386**  
( $\varnothing$  44 mm)

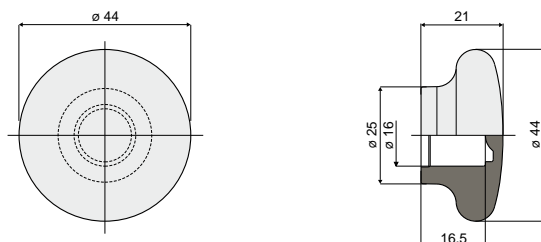

Code  
386 / 84124

**MATERIALS:** Handle in reinforced polypropylene, orange colour.  
**FEATURES:** To be used as protection for the pins edges; can be used with pin Part.301 (Dp = 16 mm.).  
**BOX QUANTITY:** 24 pieces.

**ON REQUEST:**

- Handles: in reinforced polypropylene, different colours.
- Box quantity: According to your request.

**Round handle** Part. **334**  
( $\varnothing$  44 mm)

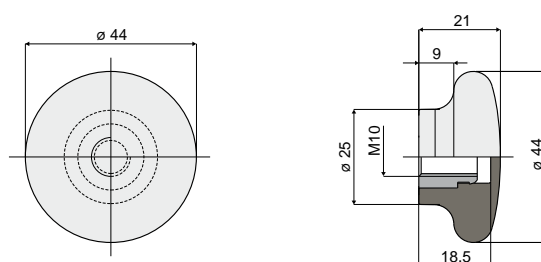

Code  
334 / 83116

**MATERIALS:** Handle made of reinforced polyamide black colour; threaded bushing made of nickel plated brass.  
**FEATURES:** Accessory to be used with heads Part.221 and 266.  
**BOX QUANTITY:** 24 pieces.

**ON REQUEST:**

- Handles: In reinforced polypropylene, other colours.
- Box quantity: According to your request.

**Round handle** Part. **337**  
( $\varnothing$  44 mm)

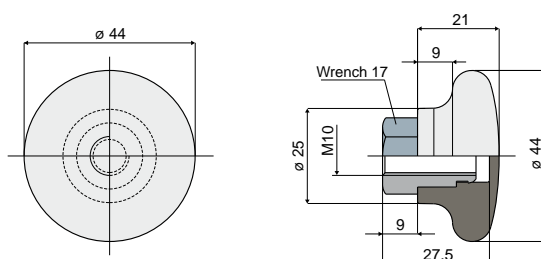

Code  
337 / 83302

**MATERIALS:** Handle made of reinforced polyamide black colour; threaded bushing made of nickel plated brass.  
**FEATURES:** Accessory to be used with heads Part.221 and 266.  
**BOX QUANTITY:** 24 pieces.

**ON REQUEST:**

- Handles: In reinforced polypropylene, other colours.
- Box quantity: According to your request.

**Round handle** Part. **338**  
( $\varnothing$  44 mm)

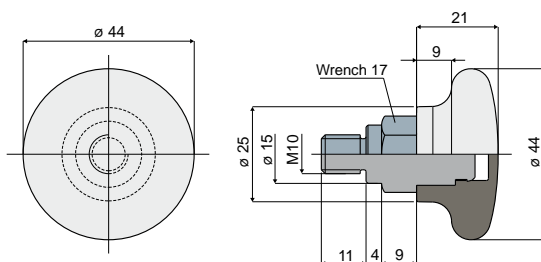

Code  
338 / 83303

**MATERIALS:** Handle made of reinforced polyamide black colour; threaded bushing made of nickel plated brass.  
**FEATURES:** Accessory to be used with head Part.223.  
**BOX QUANTITY:** 24 pieces.

**ON REQUEST:**

- Handles: In reinforced polypropylene, other colours.
- Box quantity: According to your request.