

Product guides and accessories

Example of application

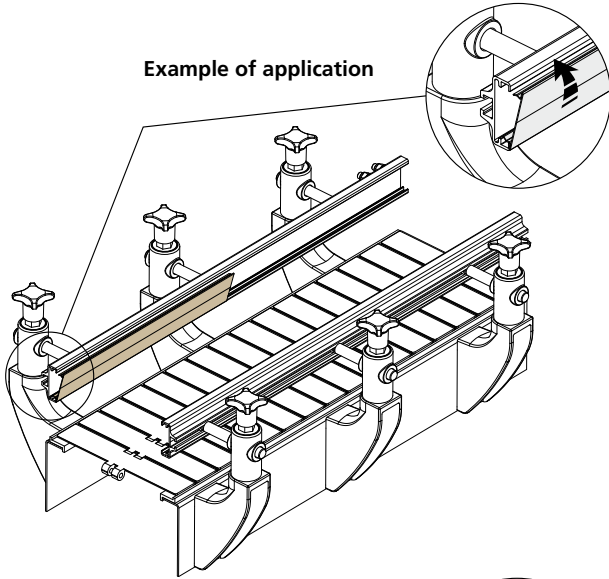

Example of application

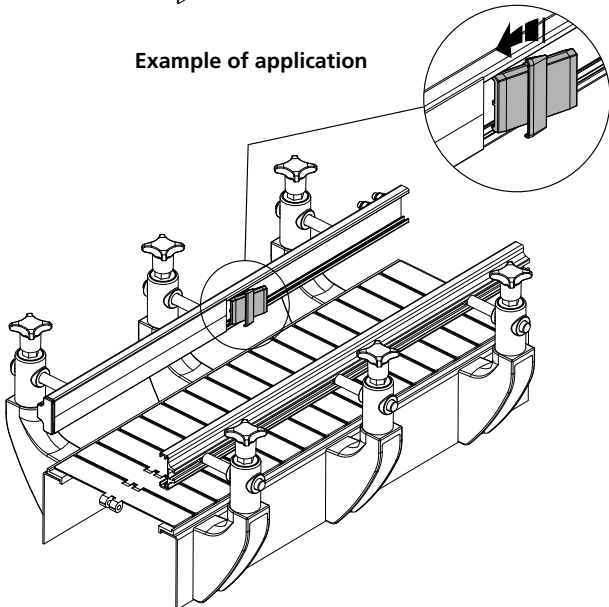

Example of application

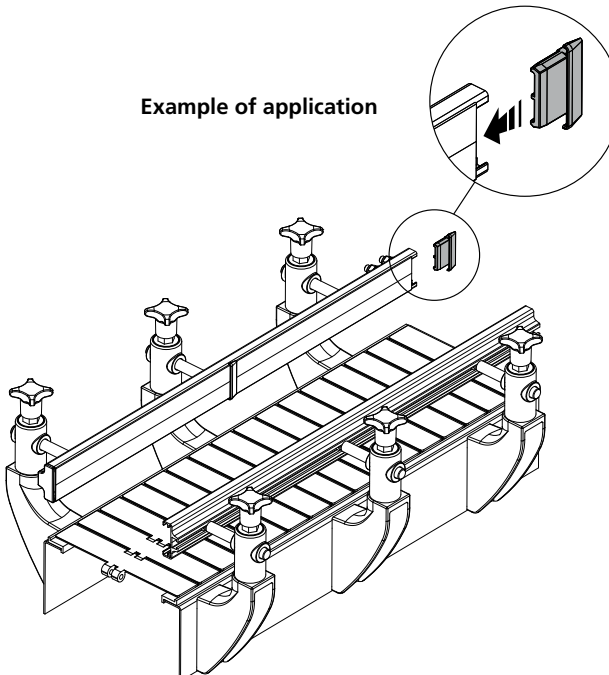

Guide profile (metallic profile)

Part. **482**

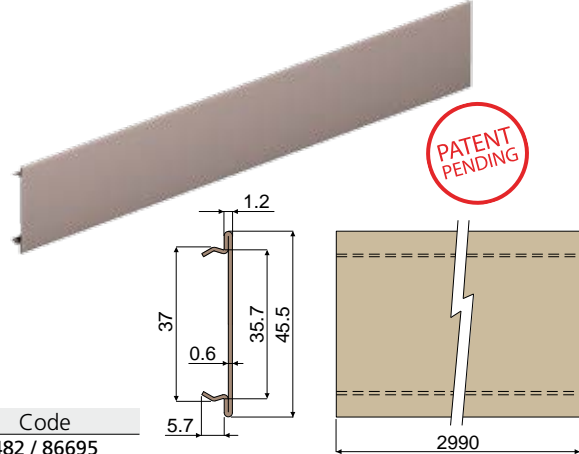

Code
482 / 86695

MATERIALS: Guide profile in stainless steel AISI 304 covered with peek.

FEATURES: Suitable for use with bundles covered with shrink-wrapped polyethylene film. The coating with peek guarantees maximum smoothness of the product. Suitable for high temperatures applications. Peek covering thickness: min. 40 µ, max 50 µ. Supplied in bars of 2.99 meters length. Snap-on assembly on profiles: Part.320, 321, 322, 323.

BOX QUANTITY: 2 bars of 2.99 meters (total 5.98 meters).

Connecting element (for Part.464, 480)

Part. **466**

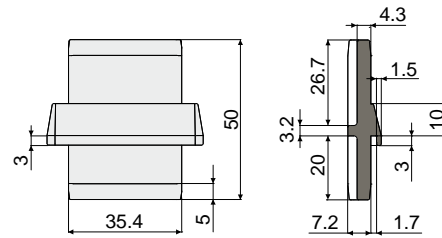

Code
466 / 85563

MATERIALS: Connecting element in grey colour polyamide and auto-lubricating additive.

FEATURES: To be used as a connecting element between the guides: Part.464, 480. The self-lubricating additive guarantees maximum smoothness of the product.

BOX QUANTITY: 8 pieces.

ON REQUEST:

- Box quantity: According to your request.

Closing cap (for Part.464, 480)

Part. **465**

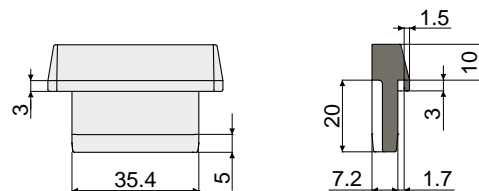

Code
465 / 85562

MATERIALS: Cap in grey colour polyamide and auto-lubricating additive.

FEATURES: To be used as a closure cap at the extremities of the guides: Part.464, 480. The self-lubricating additive guarantees maximum smoothness of the product.

BOX QUANTITY: 8 pieces.

ON REQUEST:

- Box quantity: According to your request.



Suitable for applications which require maximum smoothness.



Suitable for use with bundles covered with shrink-wrapped polyethylene film.



Suitable for high temperatures applications.