

# Product guides and accessories

Extruded product guide rails supplied in coils of 50 Mt. for plates from 6 to 7 mm. Part. **369**

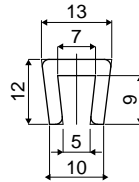

Code
369 / 83725

MATERIALS: Extruded UHMWPE white colour.  
 BOX QUANTITY: This item is sold in Mt. - Min. 50 Mt.  
 ON REQUEST:  
 • Guide profiles: Different colours and lengths.

Extruded product guide rails in coils of 60 Mt. Part. **370**

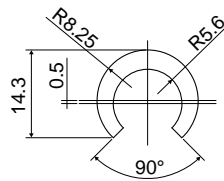

Code
370 / 83726

MATERIALS: Extruded HMWPE white colour.  
 BOX QUANTITY: This item is sold in Mt. - Min. 60 Mt.  
 FEATURES: To be used with 12 mm diameter rods.  
 ON REQUEST:  
 • Guide rails: Different colours and lengths.

Extruded product guide rails in coils of 60 Mt. Part. **371**

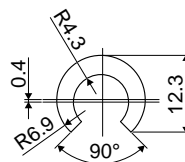

Code
371 / 83727

MATERIALS: Extruded HMWPE white colour.  
 BOX QUANTITY: This item is sold in Mt. - Min. 60 Mt.  
 FEATURES: To be used with 10 mm diameter rods.  
 ON REQUEST:  
 • Guide rails: Different colours and lengths.