

SPECIAL PRODUCTS 2025

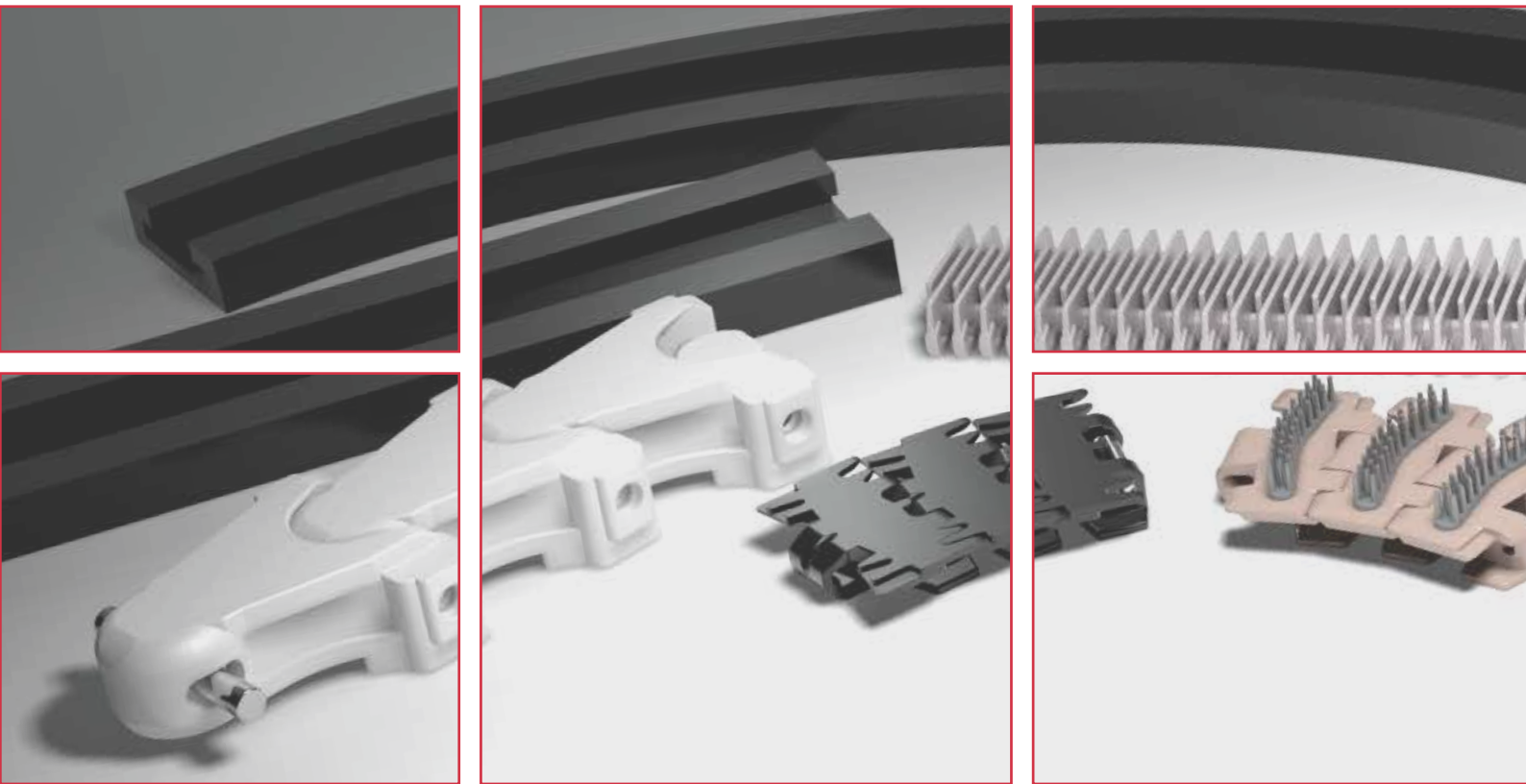

teCom
Technology Components

Special products

Part	Pag.
700	179
702	178
704	179
705	184
706	184
707	184
710	180
711	181
713	178
714	182
715	183
716	183
717	183
718	182
719	182
720	183
Corner tracks	185
Straight tracks	185

The products shown in this part are available only on request

Chains and accessories

			
Part. 702 pag. 178	Part. 713 pag. 178	Part. 700 pag. 179	Part. 704 pag. 179
New 		New 	New 
Part. 710 pag. 180	Part. 711 pag. 181	Part. 719 pag. 182	Part. 714 pag. 182
New 	New 	New 	New 
Part. 718 pag. 182	Part. 715 pag. 183	Part. 717 pag. 183	Part. 716 pag. 183
New 			
Part. 720 pag. 183	Part. 705 pag. 184	Part. 706 pag. 184	Part. 707 pag. 184

Corner and straight tracks

	
Corner tracks pag. 185	Straight tracks pag. 185

Chains and accessories

Part. **702** Top plate (for roller chains)



Code
702 / 86231

MATERIALS: Top plate made of brown colour acetal.

FEATURES: Mounting with roller chains type ASA 40 Sidebow.

BOX QUANTITY: 24 pieces.

ON REQUEST:

- Chain: Type Asa 40 Sidebow.
- Box quantity: According to your request.

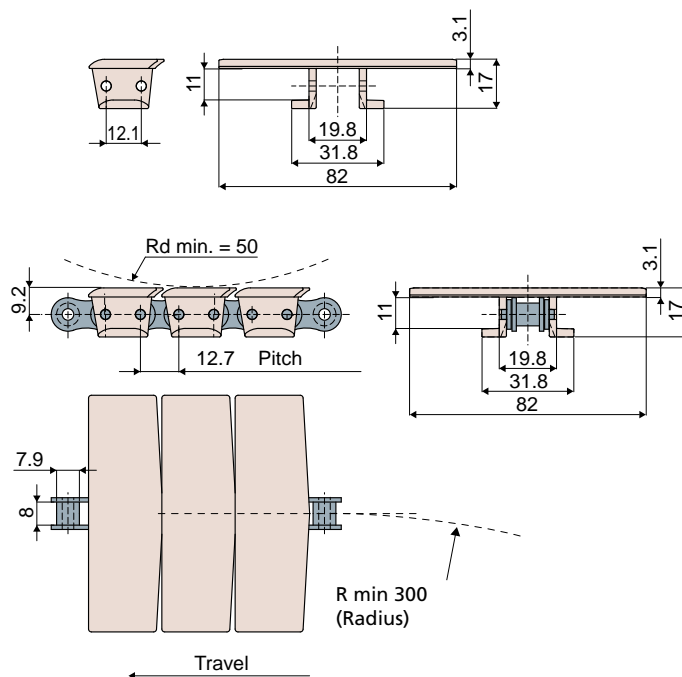

Part. **713** Sideflex chain with rubber top (879 TAB BO)

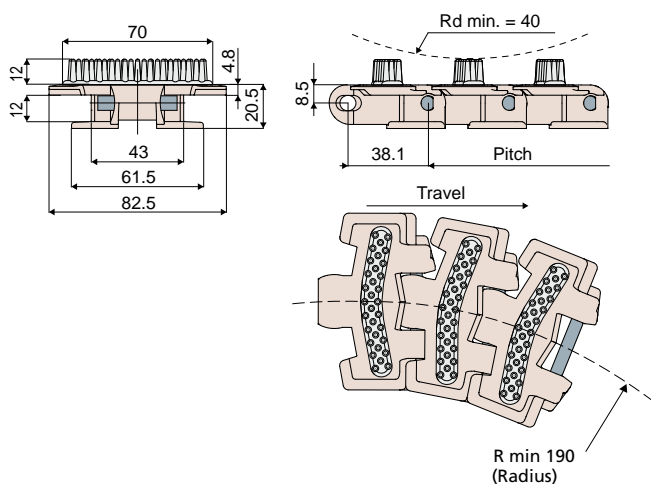
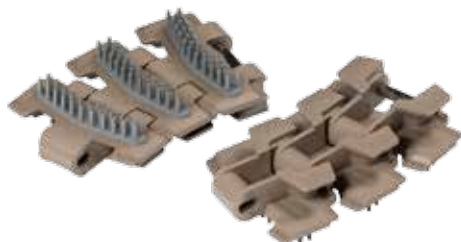

Code
713 / 87153

MATERIALS: Top plates in brown colour acetal; grey colour thermoplastic rubber; pins in stainless steel AISI 304.

FEATURES: To be used with wheels:

Part.310, 457, 456, 455, 454, 458, 459; ideal for elevators. Max. working load: 2100 N.

BOX QUANTITY: 3,05 Mt.

Example of application

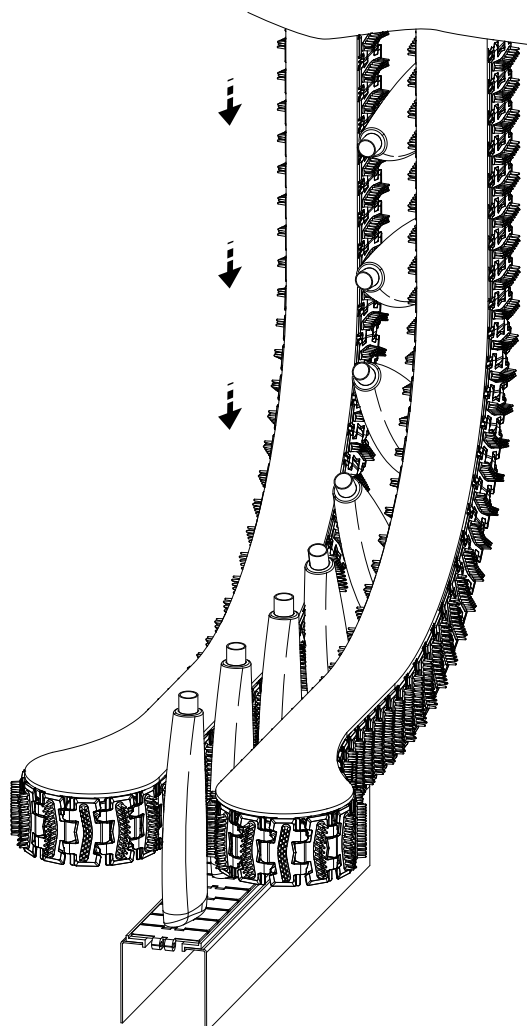

Chains and accessories

Example of application

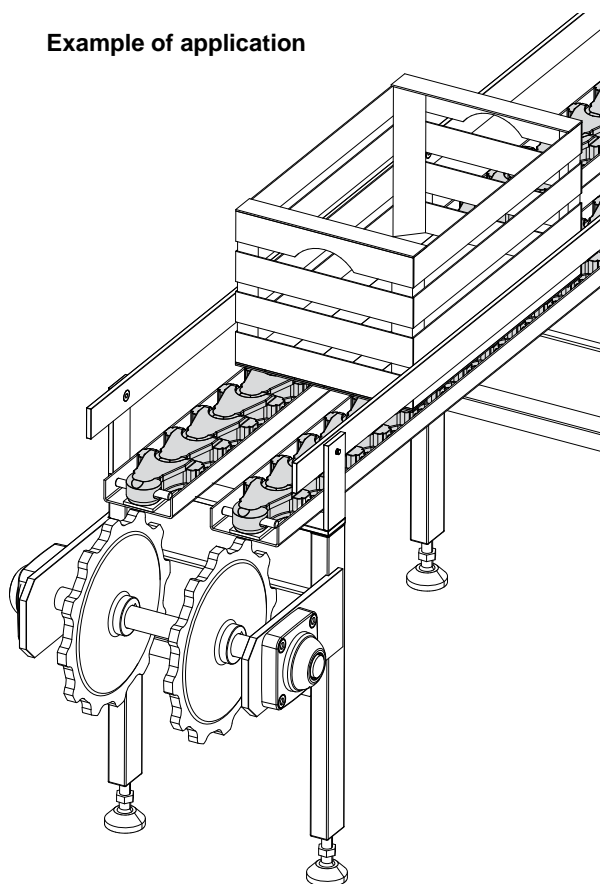

Cardanic chain

(sideflexing for important loads; pitch 80 mm)

Part. **700**

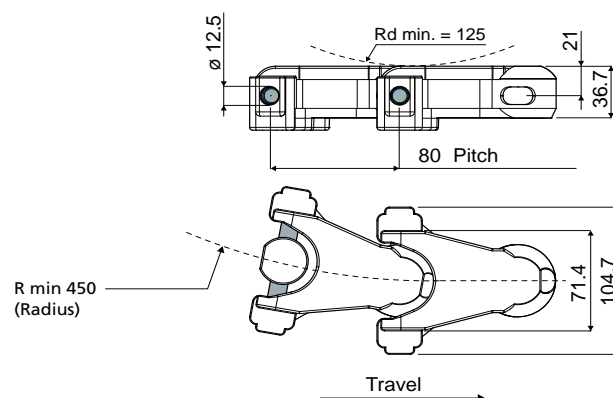

Code

700 / 84113

MATERIALS: Chain made of natural acetal; notch made of polyamide; pin made of stainless steel AISI 430.

FEATURES: To be used in the conveyor systems; for important loads (breaking load: 19600 N).

BOX QUANTITY: 3,040 meters.

Sprocket 12 teeth

(for cardanic chain Part. 700)

Part. **704**

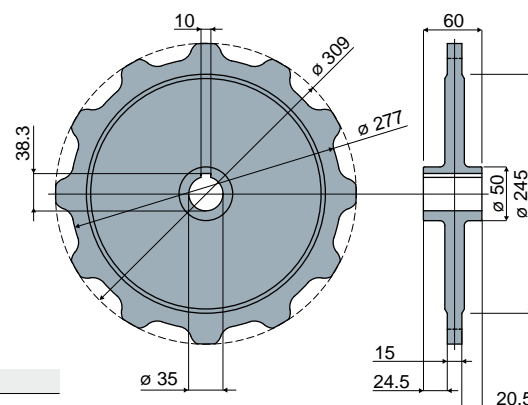

Code

704 / 84207

MATERIALS: Sprockets in zinc plated steel.

FEATURES: To be used with chain Part.700.

BOX QUANTITY: 2 pieces.

ON REQUEST:

- Box quantity: According to your request.

Chains and accessories

Part. **710** Sideflex chain (879 TAB Safety Finger)

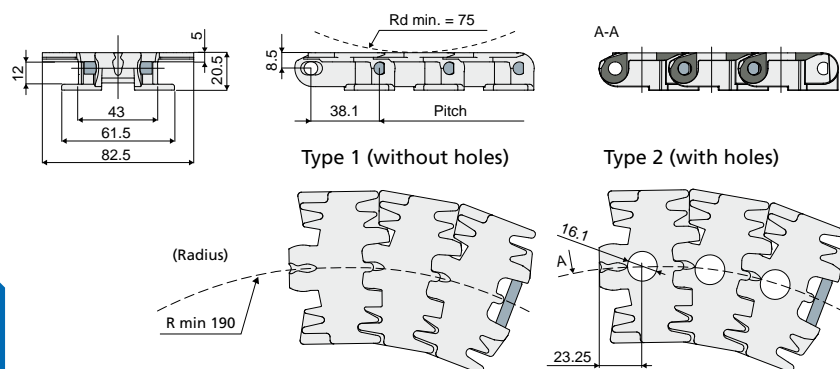

Code	Type	Material	Colour
710 / 85400	1	Acetal	White
710 / 86206	1	Acetal	Brown NEW
710 / 86096	1	Electroconductive acetal	Black
710 / 90438	2	Acetal	White NEW

MATERIALS: Top plates made of white or brown colour acetal or black colour electroconductive acetal; pins made of stainless steel AISI 304.

FEATURES: To be used with wheels:

Part.310, 457, 456, 455, 454, 458, 459. Max. working load: 2100 N.

The version with holes (Type 2) can be used in systems where the release of shavings during the transport phases is expected (see example alongside); the holes facilitate the disposal of the shavings.

BOX QUANTITY: 3,05 Mt.

Example of application

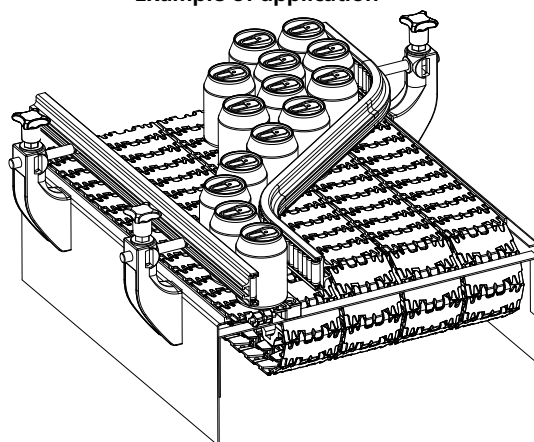

Example of application

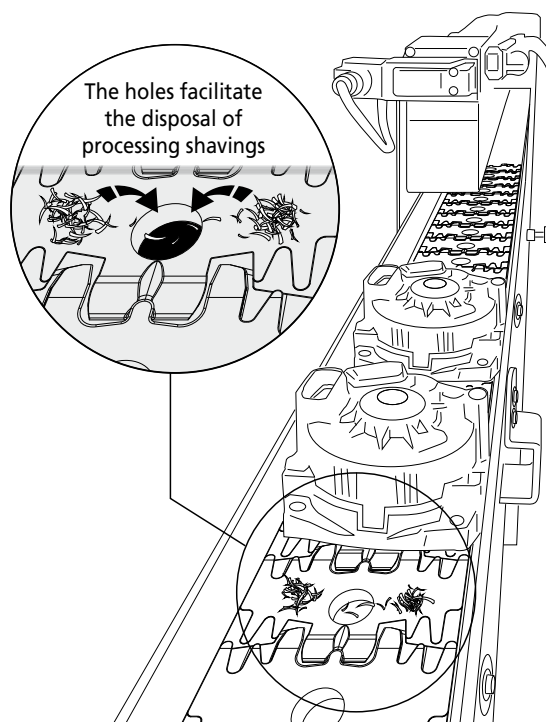

Chains and accessories

Example of application

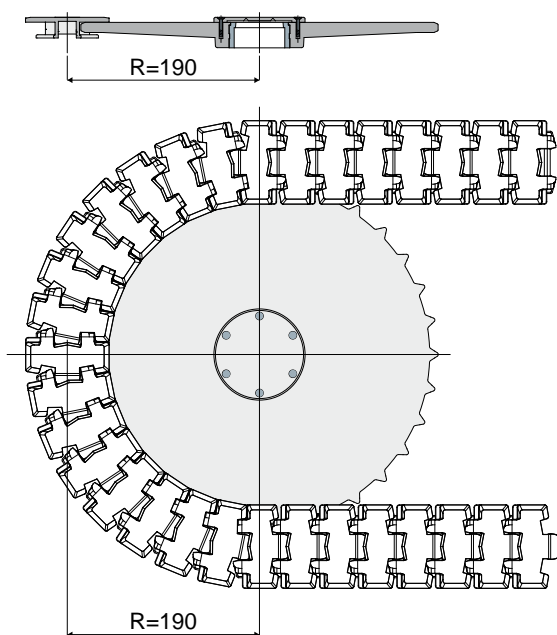

Sideflex chain (879 TAB BO)

Part. **711**

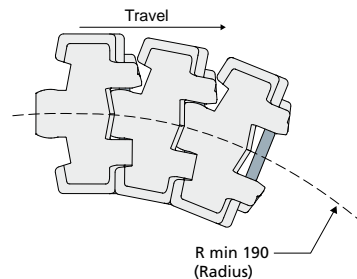
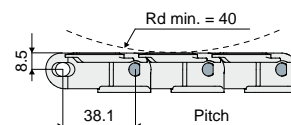
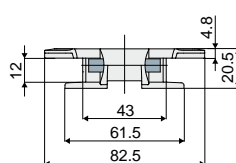

Code	Material	Colour
711 / 86729	Acetal	Brown
711 / 86730	PA + auto-lubricating additive	Black

MATERIALS: Top plates in brown colour acetal or in black colour polyamide with auto-lubricating additive; pins in stainless steel AISI 304.

FEATURES: To be used with wheels:
Part.310, 457, 456, 455, 454, 458, 459.
Max. working load: 2100 N.

BOX QUANTITY: 3,05 Mt.

Chains and accessories

Example of application

Part. 719 Bucket conveyor (pitch 130 mm.)

NEW

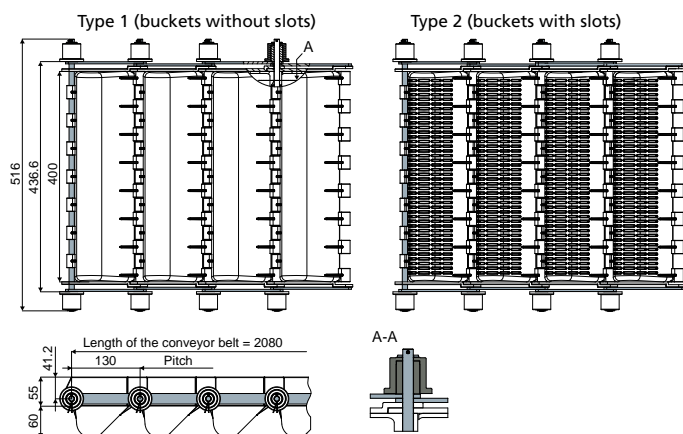
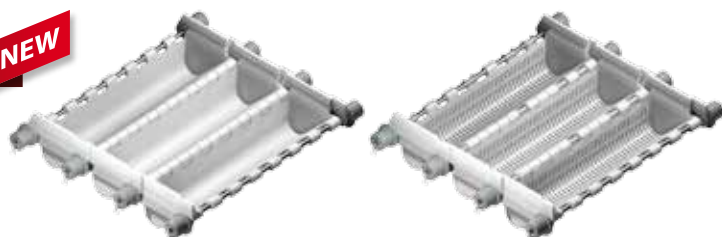

MATERIALS: Buckets and side panels in polypropylene, white colour; pins, connecting rods and split pins in stainless steel AISI 304; rollers in polyamide.

FEATURES: For use in lifting transport. Available in versions with and without slots.

BOX QUANTITY: 2.08 m (16 buckets).

ON REQUEST:

- Conveyors: In different colours.
- Box quantity: According to your request.

Code	Type
719 / 90435	1
719 / 90436	2

Part. 714 Bucket (for Part.719)

NEW

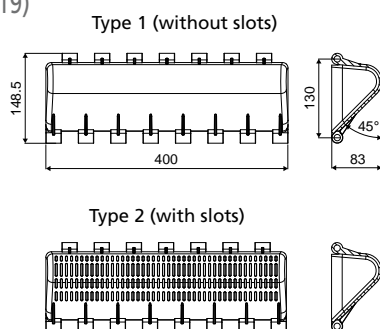
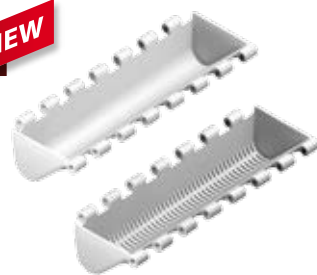

Code	Type
714 / 90428	1
714 / 90429	2

MATERIALS: Buckets in polypropylene, white colour.

FEATURES: To be used in the bucket conveyors Part.719. Available in versions with and without slots.

BOX QUANTITY: 25 pieces.

ON REQUEST:

- Buckets: In different colours.
- Box quantity: According to your request.

Part. 718 Pin (for Part.719)

NEW

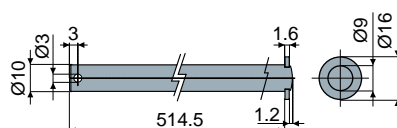

Code
718 / 90434

MATERIALS: Pin and washer in stainless steel AISI 304.

FEATURES: To be used in the bucket conveyors Part.719. **PACKAGING:** 25 pieces.

ON REQUEST:

- Box quantity: According to your request.

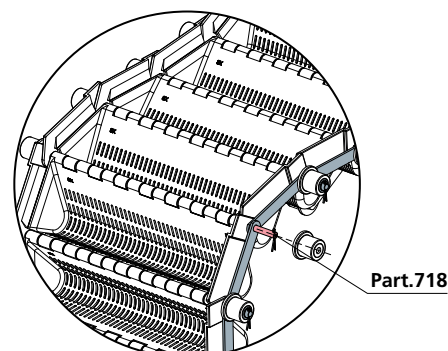
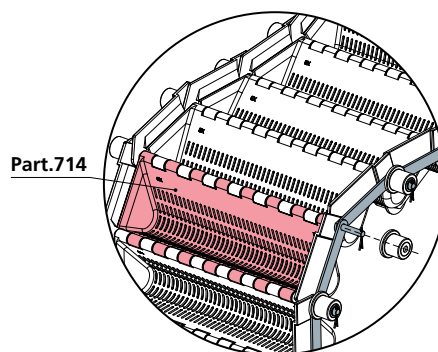
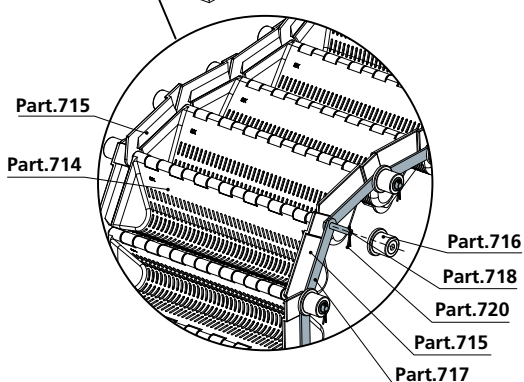
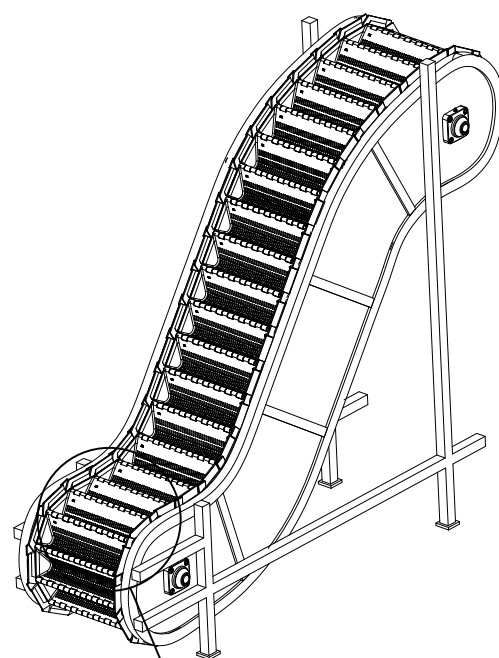

Chains and accessories

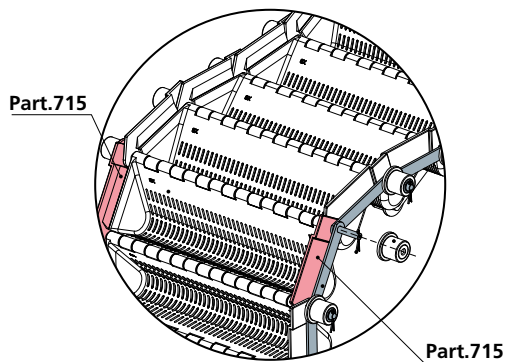

Part.715

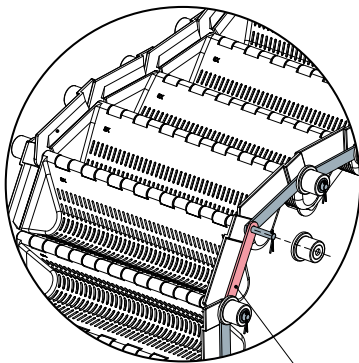

Part.717

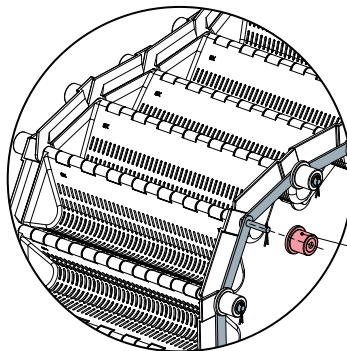

Part.716

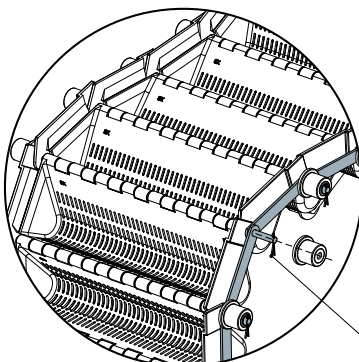

Part.720

Side panel (for Part.719)

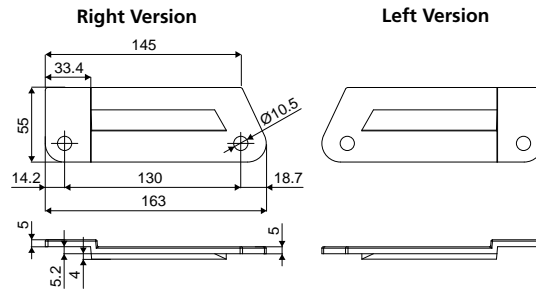
Part. **715**

Code	Version
715 / 90430	Left
715 / 90431	Right

MATERIALS: Side panels in polypropylene, white colour.
FEATURES: To be used in the bucket conveyors Part.719.
BOX QUANTITY: 25 pieces.

ON REQUEST:

- Side rails: In different colours.
- Box quantity: According to your request.

Connecting rod (for Part.719)

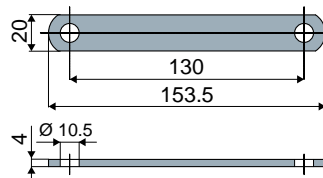
Part. **717**

Code
717 / 90433

MATERIALS: Connecting rods in stainless steel AISI 304.
FEATURES: To be used in the bucket conveyors Part.719.
BOX QUANTITY: 50 pieces.

ON REQUEST:

- Box quantity: According to your request.

Roller (for Part.719)

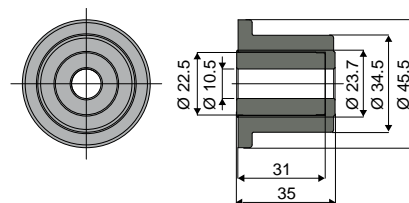
Part. **716**

Code
716 / 90432

MATERIALS: Rollers in polyamide grey colour.
FEATURES: To be used in the bucket conveyors Part.719.
BOX QUANTITY: 50 pieces.

ON REQUEST:

- Rollers: In different colours.
- Box quantity: According to your request.

Split pin (for Part.719)

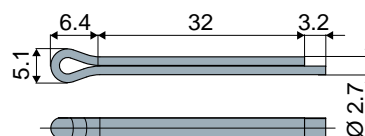
Part. **720**

Code
720 / 90827

MATERIALS: Split pin in stainless steel AISI 304.
FEATURES: To be used in the bucket conveyors Part.719.
PACKAGING: 25 pieces.

ON REQUEST:

- Box quantity: According to your request.

Chains and accessories

Loose link for belt

Part. **705**

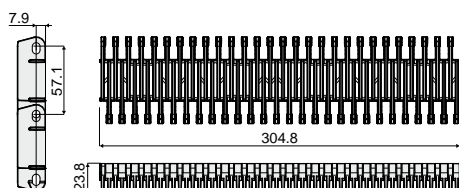
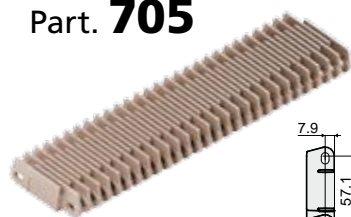

Code
705 / 84208

MATERIALS: Loose links in light brown polypropylene.

FEATURES:

- **Use:** Perfect for use in the food industry, it guarantees a uniform conveyor surface.
- **Max working load:** 29200 N/m (1 mt. belt at + 20°C).
- **Working temperature:** from +5°C to +105°C.
- **Open surface:** 34%
- **Assembly:** with a pin diameter 6 mm (not supplied).

BOX QUANTITY: 24 pieces.

ON REQUEST:

- Loose links: In acetal.
- Belts: Supplied assembled.
- Box quantity: According to your request.

Part. **706** Sprocket / Idler wheel (for Part.705)

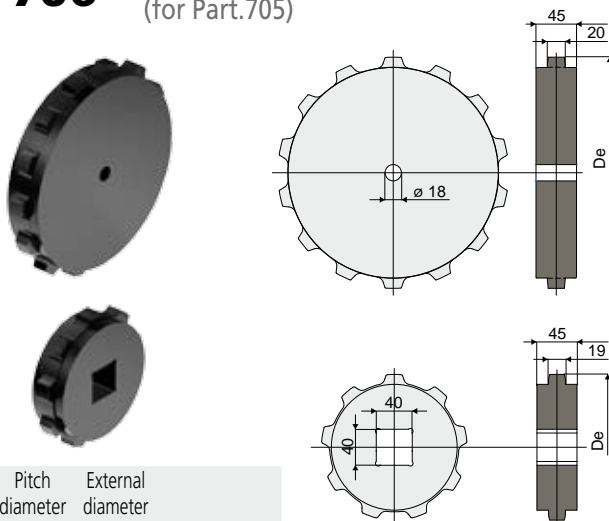

N. teeth	Pitch diameter Dp (mm)	External diameter De (mm)	Code
14	256,82	256,5	706 / 84209
9	167,08	164,1	706 / 85850

MATERIALS: Sprockets in black polyamide.

FEATURES: To be used with modular belts Part.705.

BOX QUANTITY: 8 pieces.

ON REQUEST:

- Box quantity: According to your request.

Part. **707** Transfer comb (for Part.705)

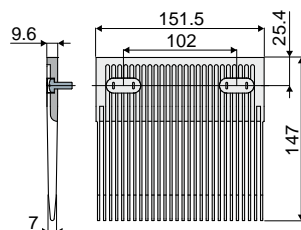
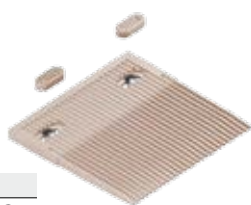

Code
707 / 88703

MATERIALS: Comb and screw caps in light brown polypropylene, M6 screws in stainless steel.

FEATURES: To be used with modular belts Part. 705.

The type of mounting depends on the operating temperatures.

BOX QUANTITY: 24 pieces.

ON REQUEST:

- Box quantity: According to your request.

Max working load (N / m)

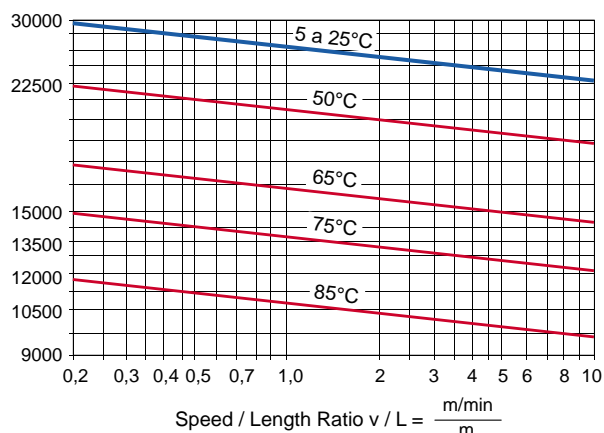

Position of the transfer comb

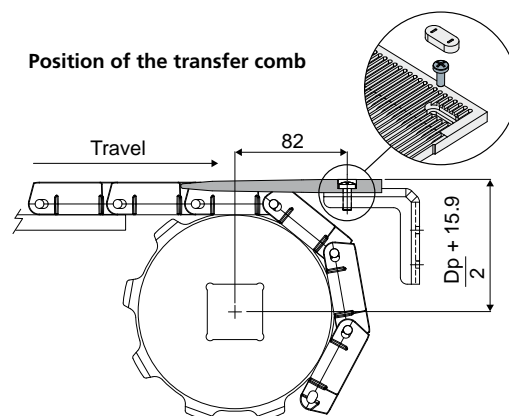

Assembly at room temperature (20° C)

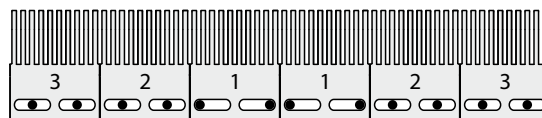

Low temperature assembly

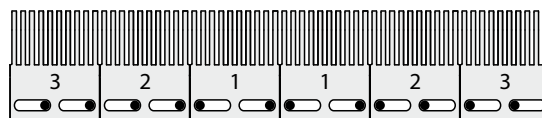

High temperature assembly

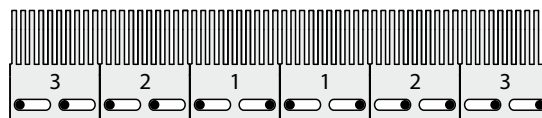

Center of the chain

Corner and straight tracks

Corner tracks

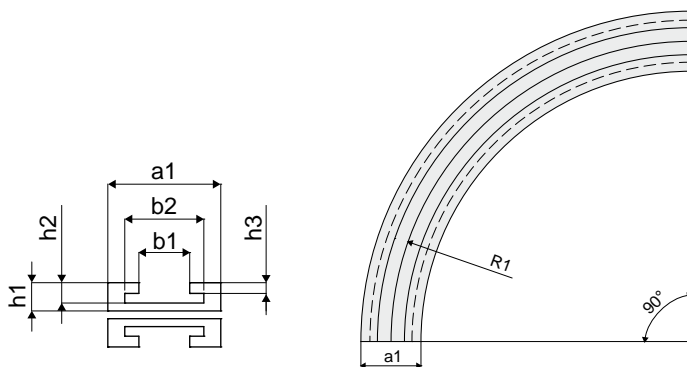

Chain type	Chain width	R1 (mm)	a1 (mm)	b1 (mm)	b2 (mm)	h1 (mm)	h2 (mm)	h3 (mm)	Track type	Material	Cod. Tecom
879TAB-K325	82,5	500	100	45	70	25	18	9,5	Carry Return	PE 1000 PE 500	83445 83446
880TAB-K325											
881TAB-K325											
8811TAB-K325											
879TAB-K450	114,3	610	125	45	70	25	18	9,5	Carry Return	PE 1000 PE 500	83449 83450
880TAB-K450											
880TAB-K454											
881TAB-K450											
8811TAB-K450											
881TAB-K750	190,5	610	200	45	70	25	18	9,5	Carry Return	PE 1000 PE 500	83451 83452
8811TAB-K750											

MATERIALS: Upper parts in PE 1000, black colour and bottom parts in PE 500 black colour.

FEATURES: To be used to drive the chain in the corner sections.

BOX QUANTITY: 2 pieces.

ON REQUEST:

- Box quantity: According to your request.

Straight tracks

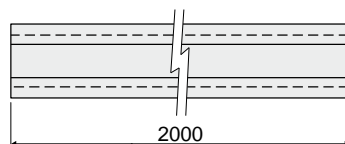
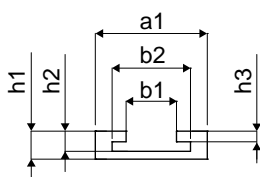

Chain type	Chain width	a1 (mm)	b1 (mm)	b2 (mm)	h1 (mm)	h2 (mm)	h3 (mm)	Material	Cod. Tecom
879TAB-K325	82,5	100	45	70	25	18	9,5	PE 500	83652
879BO-K325									
880TAB-K325									
881TAB-K325									
8811TAB-K325									
879TAB-K450	114,3	125	45	70	25	18	9,5	PE 500	83653
879BO-K450									
880TAB-K450									
881TAB-K450									
8811TAB-K450									

MATERIALS: Straight tracks in PE 500 black colour.

FEATURES: To be used to drive the chain in the straight sections.

BOX QUANTITY: 2 pieces.

ON REQUEST:

- Box quantity: According to your request.



teCom
Technology Components

TECOM S.r.l.

Via A.M. Ampère, 43 - 42017 Novellara (RE) - Italy

Tel.: (+39) 0522-651203 Tel.: (+39) 0522-651369

Web: <https://www.tecomsrl.it> e-mail: info@tecomsrl.it